



# HEAD LAKE ROTARY PARK

master plan presentation to council

Prepared by:  
Basterfield & Associates Inc.



# HEAD LAKE ROTARY PARK MASTER PLAN

PRESENTATION TO COUNCIL

DECEMBER 15, 2020

1. Introductions
2. Stakeholder Workshops Summary
3. Presentation of Conceptual Master Plan

# IMPROVEMENTS WORK SHOP SUMMARY

## DISCUSSION QUESTION 1:

Excluding the relationship to the Lake and Creek what are the top 3 features (places or things) you value most about the park?

- Diversity of activities in the park – playgrounds, pathways, tennis, beach, community events
- Pathways / trails / bridges
- Open space and natural areas – relationship of green space to park and village
- Band shell



# IMPROVEMENTS WORK SHOP SUMMARY

## DISCUSSION QUESTION 2:

Given the uses and activities that currently exist are there any features (places or things) that should be added to the park?

- Visitor centre with flush toilets
- Shade – shelter and trees suggested
- Shelter – shade / picnic pavilion or tents
- Splash pad
- Signage (subtle, natural looking) – wayfinding / paths, gateway, interpretive, and communication
- Security – more lighting, police presence, trim trees, cameras



# IMPROVEMENTS WORK SHOP SUMMARY

## DISCUSSION QUESTION 3:

Are there any places, things, or activities that need improvement, repair or upgrading?

- Drainage to eliminate pooling water
- Upgrade / repair all pathways – drainage, widths, etc.
- Repair bridges
- Upgrade / repair fountain
- Flower bed placement at centre of path
- Accessibility – playground, bandshell, pathways washrooms, etc.
- Washrooms
- Tennis courts
- Enforce no smoking

# IMPROVEMENTS WORK SHOP SUMMARY

## DISCUSSION QUESTION 4:

What are the top 3 things you like least about the park?

- Poor drainage
- Condition of washrooms
- Location of caboose
- Lack of signage – wayfinding / paths, gateway, interpretive, and communication
- Maintenance of park – pathways, tennis courts, planters outdated

# CONCEPTUAL PLAN







## 1. Beach Improvements

- Extend a seasonal or permanent accessible walkway to high water mark on beach
- Consider importing clean beach sand above existing water level of beach
- Define park walkway and edge of parking lot with new curbing
- Regrade and establish stone cobble and boulder drainage way along north end of beach to control erosion
- Relocate boat-racks south of new drainage way or relocate to an area near the visitor centre
- Plant shade trees in beach area along edge of new walkway

## 2. New Splash Pad

- New walkways to define splash pad area
- Relocate existing vault toilets to edge of new pathway
- Provide paved seating/viewing area and shade pavilion on east side of new walkway
- Utilize existing building for splash pad mechanical system
- Preserve and maintain large existing tree
- Splash pad becomes part of main entrance to north end of park
- Splash pad location has been set to the north to avoid settlement of mechanical and concrete systems





### 3. Tree Planting

- New native tree planting along inside edge of pathways to frame open lawn area.
- Natural shoreline plantings to remain

### 4. New Off-Leash Dog Park

- New fenced in off-leash dog park with double gate entry system and picnic tables

### 5. Beach Improvements

- Extend concrete paved surface from pathway to sand beach
- Refresh and enlarge beach area
- Provide semi circular pollinator garden on east side of pathway including beach signage





## 6. Outdoor Stage Area

- Extend pathway around viewing area on lower side of slope for accessibility and viewing to the Lake
- Provide a paved apron at the front of the stage
- Provide a set of steps leading from the new north-west formal walkway up to the stage viewing area

## 7. Bridge Crossing and North Pathway

- New bridge suitable for park maintenance vehicles
- New asphalt pathway to follow the river edge and connect to new north and east park entrances
- Modify alignment of existing path to the beach
- Interpretive panel depicting Haliburton's milling history located in pathway island





## 8. Water Feature

- Reconstructed water feature near current location redesigned with no standing water to meet current Public Health requirements
- Reduced size and weight to limit settlement but maintain a visible height from York Street
- Consider a milling theme for the redesign and utilization of some of the current stones

## 9. Formal Park and Event Tent Space

- Organized space for 40-60 vendor tents
- Re-graded with a reinforced turf system to support vehicular traffic and limit ground settlement
- 3m wide formal concrete walkways suitable for vehicular traffic during event set up and maintenance
- Gardens and small native trees along pathways
- Realign existing pathway coming from the west to meet south-west corner of the new walkways
- Lake side edge and west side of formal park space to be used for snowmobile parking. Fence and control access points to parking





## 10. Main Park Entrance and Event Staging Area

- Decorative paving and curbing across front of park from Rails End Gallery to the new Visitor Centre Building
- Control bollards to restrict vehicular access
- Decorative light/banner poles to match the Cenotaph Square and Main Street
- Benches, waste containers, wayfinding and directional signage

## 11. Park Building/Visitor Centre Plaza

- New curbing and vehicular circulation to control access
- Decorative paving through laneway
- Traffic control gates for major events and festivals



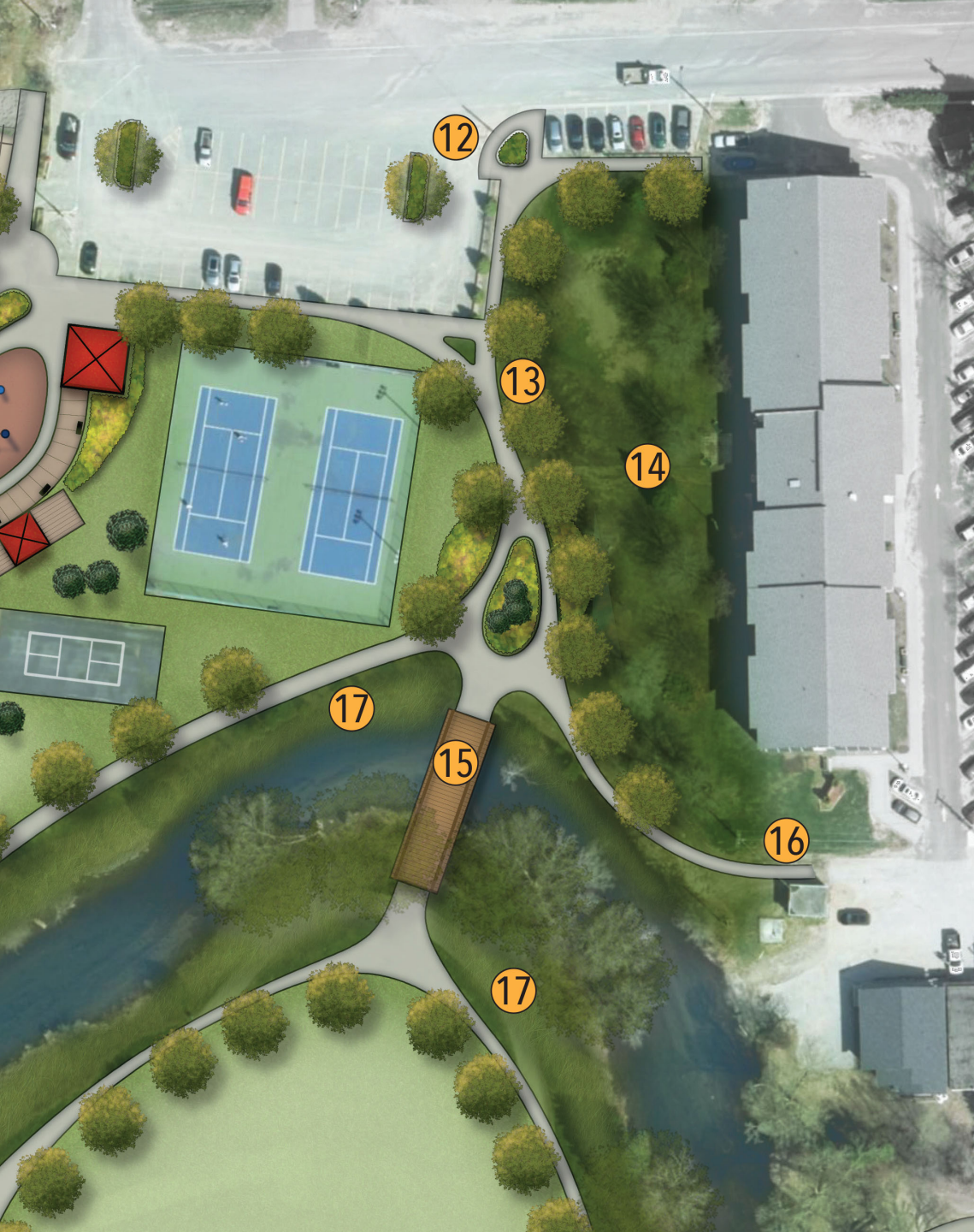

## 12. Parking Lot Improvements

- Remove wood planters regrade as required and install new barrier curb and sidewalk around perimeter of parking lot
- Install curbed planting islands to define and manage central parking spaces

## 13. New North-End Pathway System

- Install new 2m wide pedestrian pathways that link Park Street and Victoria Street with north-end parking lot and follow the north river edge to existing bridge

## 14. New Landscape Improvements

- Add opportunity for fruit and edible tree species
- Consider community garden space
- Co-ordinate with residents of adjacent housing regarding important views to the lake



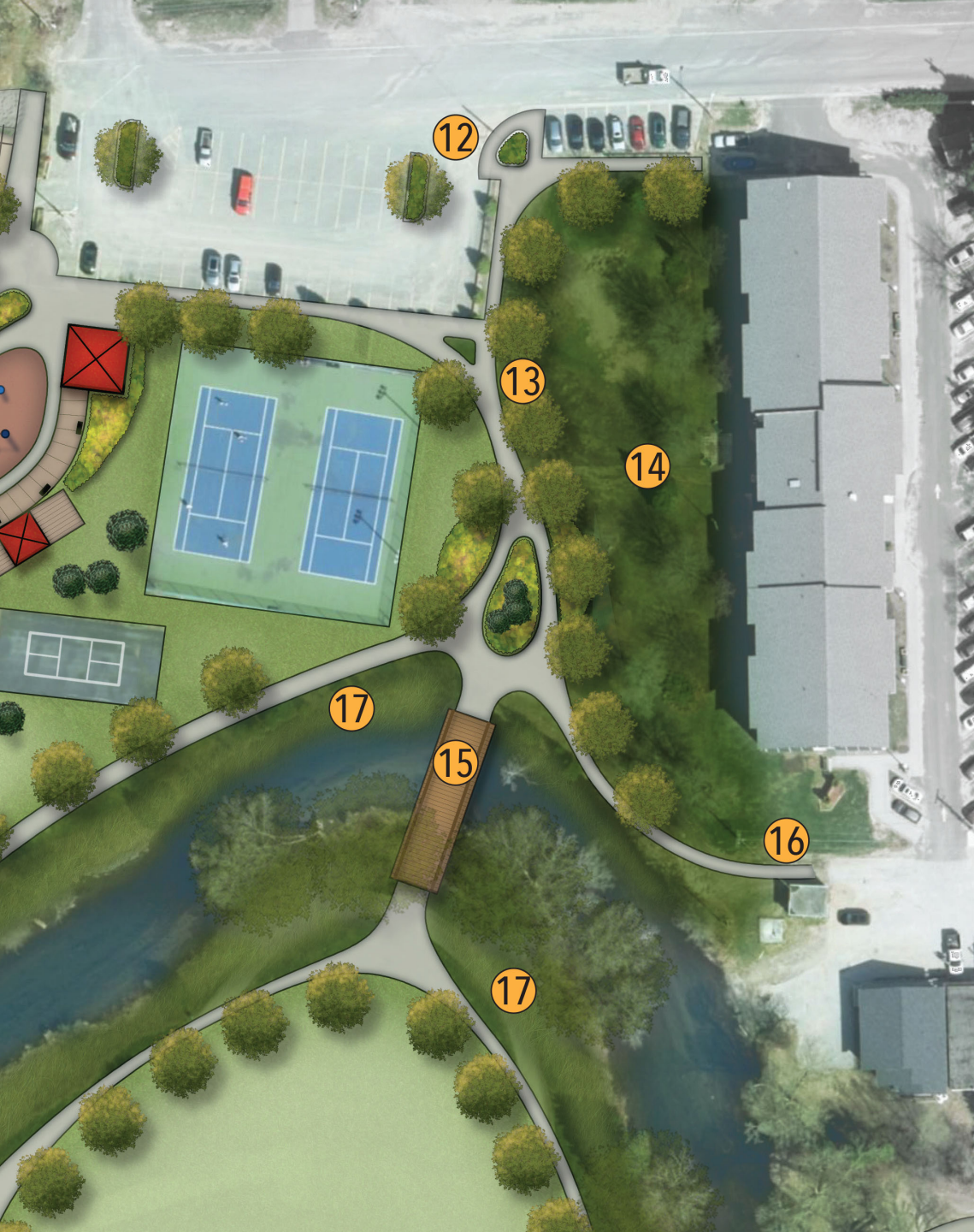

## 15. New Bridge

- Consider placement of a new bridge suitable for park maintenance vehicles
- Bridge will facilitate better access from the north residential areas to the south end of the park playground
- Bridge will enhance pedestrian circulation and exercise opportunities

## 16. Victoria Street Entrance

- Formalize existing beaten pathway with new asphalt path connection linking existing sidewalk and park
- Consider new park sign and wayfinding map

## 17. Naturalization Plantings

- Enhance existing naturalization plantings along river to stabilize river banks, improve pollinator opportunities and deter geese access to turf areas



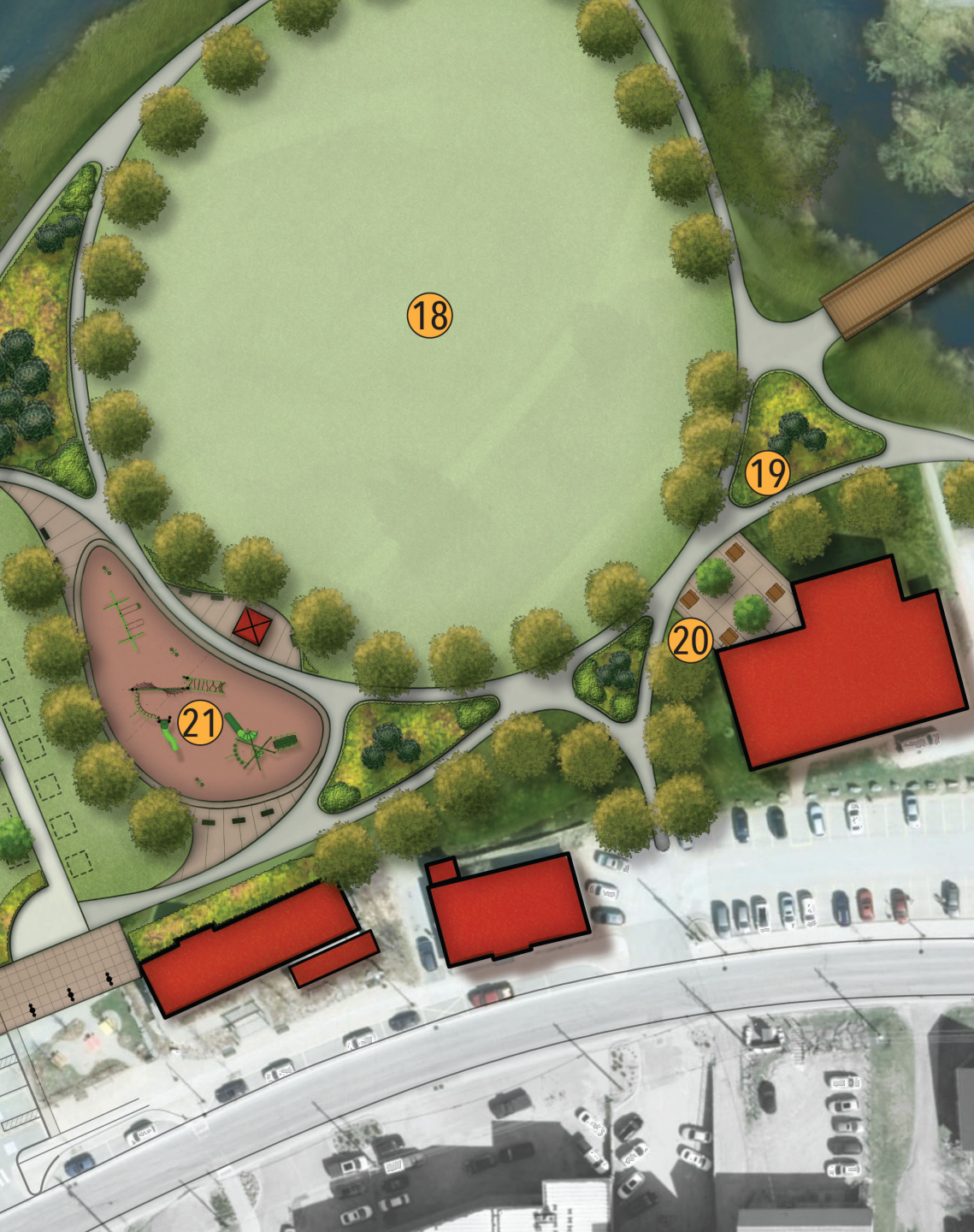

## 18. Central Green

- Establish a large central lawn area with possible reinforced turf system under perimeter pathway and 8m into the lawn area to facilitate more vendor tent space
- Remove raised fill area with existing evergreen trees and grade area to extend the usable space of the open lawn area
- Line pathway with new native shade trees to improve the pedestrian park experience
- Disc golf course to remain with adjustments as needed

## 19. New Pathway System and Links

- Establish a new “flowing” pathway system approximately 3m wide with planting islands and pathway linkages to municipal parking lots, central green and event space, playground and library
- Planting islands constructed to provide drainage infiltration areas, shade and ornamental and pollinator plantings
- Maintain and upgrade existing Drag River walking trail along the river edge



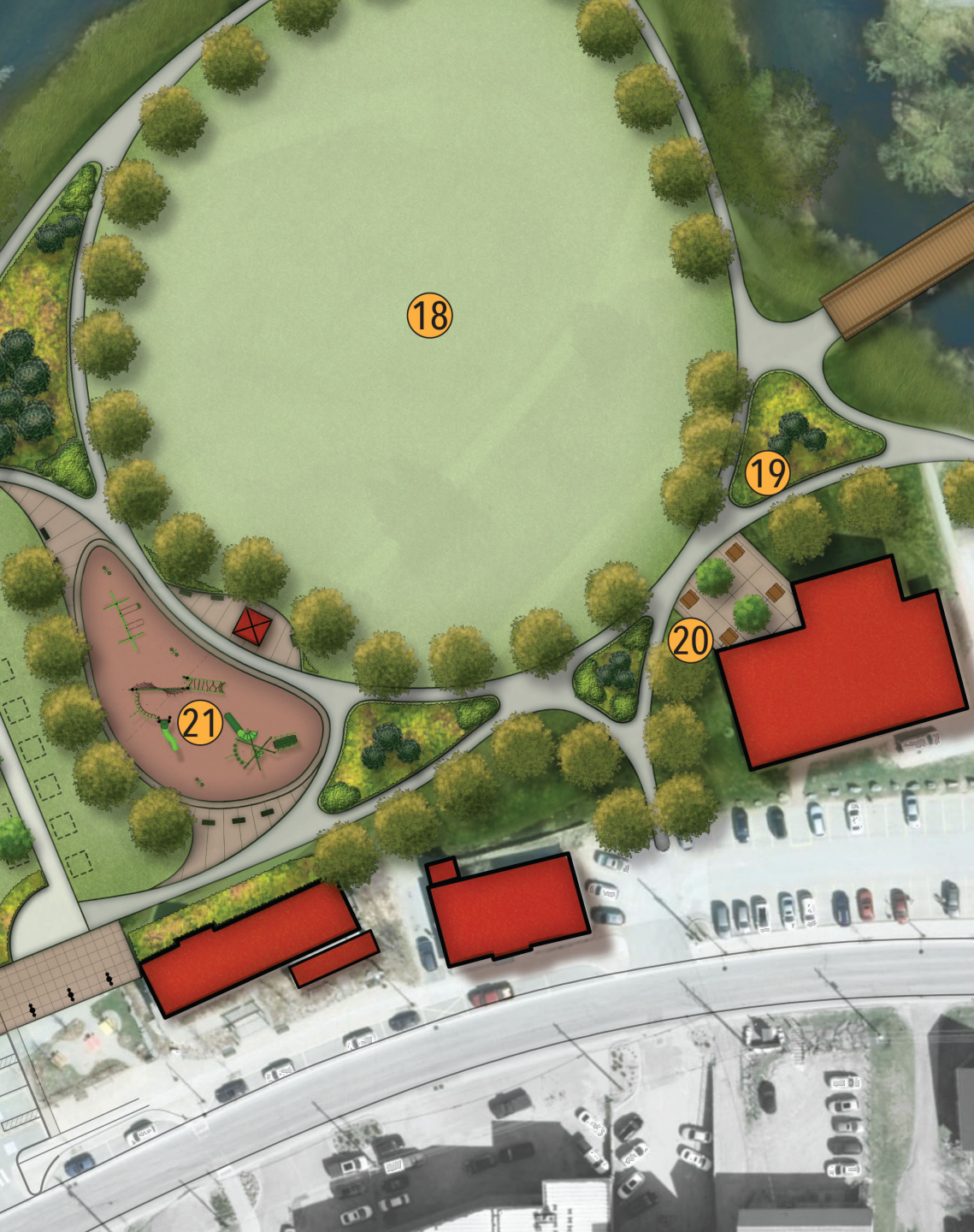

## 20. Library Park Plaza

- Locate new pathway close enough to library to deter loitering and provide an opportunity to establish an outdoor plaza with picnic tables, park lights and reading benches

## 21. Playground Area

- Relocate, reuse and add to existing playground apparatus to create a new large play area
- Provide paved bench and viewing areas around perimeter of playground and a centrally located shade pavilion with similar detailing and materials used at new washroom building and new north end shade structures
- Provide new gardens and historical railway interpretive panel across front of Rails End