

Proposed Site Plan

SURVEYOR'S PLAN, PROPERTY REPORT
 PART 1) PLAN AND TOPOGRAPHIC DETAIL OF
 PART OF LOT 14
 CONCESSION B
 (DISPOSITIVE SURVEY OF PROPOSED)
 TOWNSHIP OF EVELSON ET AL.
 COUNTY OF HALIFAX
 SCALE 1:500
 VLADIMIR DOSEN SURVEYING, D.L.S.
 1000-1000-1000-1000



- LEGEND
- 1. SURVEYOR'S BOUNDARY
 - 2. SURVEYOR'S BOUNDARY
 - 3. SURVEYOR'S BOUNDARY
 - 4. SURVEYOR'S BOUNDARY
 - 5. SURVEYOR'S BOUNDARY
 - 6. SURVEYOR'S BOUNDARY
 - 7. SURVEYOR'S BOUNDARY
 - 8. SURVEYOR'S BOUNDARY
 - 9. SURVEYOR'S BOUNDARY
 - 10. SURVEYOR'S BOUNDARY
 - 11. SURVEYOR'S BOUNDARY
 - 12. SURVEYOR'S BOUNDARY
 - 13. SURVEYOR'S BOUNDARY
 - 14. SURVEYOR'S BOUNDARY
 - 15. SURVEYOR'S BOUNDARY
 - 16. SURVEYOR'S BOUNDARY
 - 17. SURVEYOR'S BOUNDARY
 - 18. SURVEYOR'S BOUNDARY
 - 19. SURVEYOR'S BOUNDARY
 - 20. SURVEYOR'S BOUNDARY
 - 21. SURVEYOR'S BOUNDARY
 - 22. SURVEYOR'S BOUNDARY
 - 23. SURVEYOR'S BOUNDARY
 - 24. SURVEYOR'S BOUNDARY
 - 25. SURVEYOR'S BOUNDARY
 - 26. SURVEYOR'S BOUNDARY
 - 27. SURVEYOR'S BOUNDARY
 - 28. SURVEYOR'S BOUNDARY
 - 29. SURVEYOR'S BOUNDARY
 - 30. SURVEYOR'S BOUNDARY
 - 31. SURVEYOR'S BOUNDARY
 - 32. SURVEYOR'S BOUNDARY
 - 33. SURVEYOR'S BOUNDARY
 - 34. SURVEYOR'S BOUNDARY
 - 35. SURVEYOR'S BOUNDARY
 - 36. SURVEYOR'S BOUNDARY
 - 37. SURVEYOR'S BOUNDARY
 - 38. SURVEYOR'S BOUNDARY
 - 39. SURVEYOR'S BOUNDARY
 - 40. SURVEYOR'S BOUNDARY
 - 41. SURVEYOR'S BOUNDARY
 - 42. SURVEYOR'S BOUNDARY
 - 43. SURVEYOR'S BOUNDARY
 - 44. SURVEYOR'S BOUNDARY
 - 45. SURVEYOR'S BOUNDARY
 - 46. SURVEYOR'S BOUNDARY
 - 47. SURVEYOR'S BOUNDARY
 - 48. SURVEYOR'S BOUNDARY
 - 49. SURVEYOR'S BOUNDARY
 - 50. SURVEYOR'S BOUNDARY
 - 51. SURVEYOR'S BOUNDARY
 - 52. SURVEYOR'S BOUNDARY
 - 53. SURVEYOR'S BOUNDARY
 - 54. SURVEYOR'S BOUNDARY
 - 55. SURVEYOR'S BOUNDARY
 - 56. SURVEYOR'S BOUNDARY
 - 57. SURVEYOR'S BOUNDARY
 - 58. SURVEYOR'S BOUNDARY
 - 59. SURVEYOR'S BOUNDARY
 - 60. SURVEYOR'S BOUNDARY
 - 61. SURVEYOR'S BOUNDARY
 - 62. SURVEYOR'S BOUNDARY
 - 63. SURVEYOR'S BOUNDARY
 - 64. SURVEYOR'S BOUNDARY
 - 65. SURVEYOR'S BOUNDARY
 - 66. SURVEYOR'S BOUNDARY
 - 67. SURVEYOR'S BOUNDARY
 - 68. SURVEYOR'S BOUNDARY
 - 69. SURVEYOR'S BOUNDARY
 - 70. SURVEYOR'S BOUNDARY
 - 71. SURVEYOR'S BOUNDARY
 - 72. SURVEYOR'S BOUNDARY
 - 73. SURVEYOR'S BOUNDARY
 - 74. SURVEYOR'S BOUNDARY
 - 75. SURVEYOR'S BOUNDARY
 - 76. SURVEYOR'S BOUNDARY
 - 77. SURVEYOR'S BOUNDARY
 - 78. SURVEYOR'S BOUNDARY
 - 79. SURVEYOR'S BOUNDARY
 - 80. SURVEYOR'S BOUNDARY
 - 81. SURVEYOR'S BOUNDARY
 - 82. SURVEYOR'S BOUNDARY
 - 83. SURVEYOR'S BOUNDARY
 - 84. SURVEYOR'S BOUNDARY
 - 85. SURVEYOR'S BOUNDARY
 - 86. SURVEYOR'S BOUNDARY
 - 87. SURVEYOR'S BOUNDARY
 - 88. SURVEYOR'S BOUNDARY
 - 89. SURVEYOR'S BOUNDARY
 - 90. SURVEYOR'S BOUNDARY
 - 91. SURVEYOR'S BOUNDARY
 - 92. SURVEYOR'S BOUNDARY
 - 93. SURVEYOR'S BOUNDARY
 - 94. SURVEYOR'S BOUNDARY
 - 95. SURVEYOR'S BOUNDARY
 - 96. SURVEYOR'S BOUNDARY
 - 97. SURVEYOR'S BOUNDARY
 - 98. SURVEYOR'S BOUNDARY
 - 99. SURVEYOR'S BOUNDARY
 - 100. SURVEYOR'S BOUNDARY

TRAVELLED ROAD (LOCALLY KNOWN AS)
 WALLINGS ROAD
 (BY UNDERTAKING BY-LAW NO. 2002-130)

Location of "Glamping Pods"

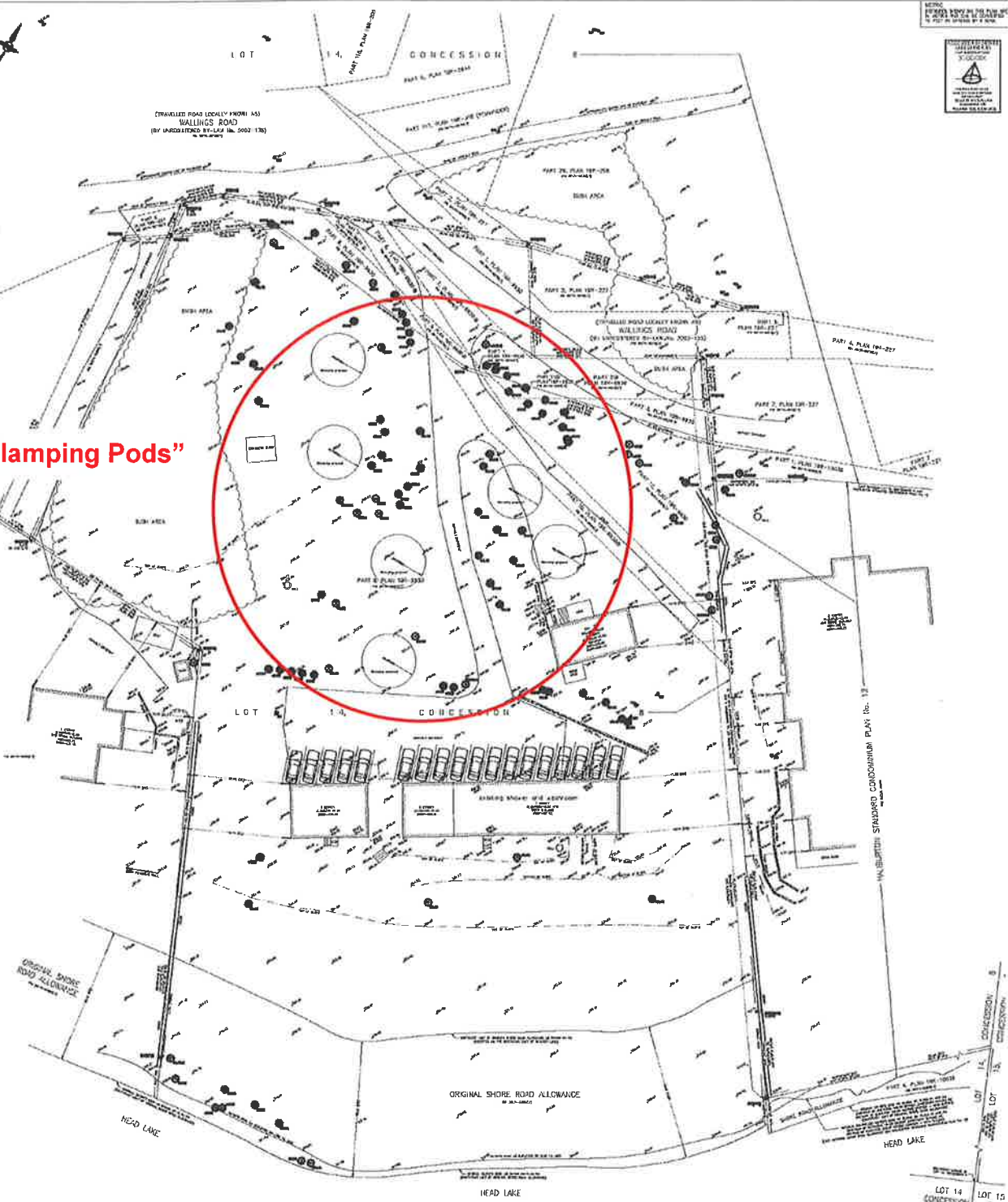

REMARKS

REMARKS NOTE:
 1. THE SURVEY WAS CONDUCTED ON THE DATE INDICATED ABOVE AND THE RESULTS ARE AS SHOWN ON THIS PLAN.
 2. THE SURVEY WAS CONDUCTED IN ACCORDANCE WITH THE SURVEY ACT AND REGULATIONS.
 3. THE SURVEY WAS CONDUCTED ON THE DATE INDICATED ABOVE.

REMARKS NOTE:
 1. THE SURVEY WAS CONDUCTED ON THE DATE INDICATED ABOVE AND THE RESULTS ARE AS SHOWN ON THIS PLAN.
 2. THE SURVEY WAS CONDUCTED IN ACCORDANCE WITH THE SURVEY ACT AND REGULATIONS.
 3. THE SURVEY WAS CONDUCTED ON THE DATE INDICATED ABOVE.

REMARKS NOTE:
 1. THE SURVEY WAS CONDUCTED ON THE DATE INDICATED ABOVE AND THE RESULTS ARE AS SHOWN ON THIS PLAN.
 2. THE SURVEY WAS CONDUCTED IN ACCORDANCE WITH THE SURVEY ACT AND REGULATIONS.
 3. THE SURVEY WAS CONDUCTED ON THE DATE INDICATED ABOVE.

SURVEYOR'S CERTIFICATE

I, THE SURVEYOR, HAVE CONDUCTED A SURVEY AND A MAP THEREOF HAS BEEN PREPARED AND THE SURVEY WAS COMPLETED ON THE DATE INDICATED ABOVE.

DATE: 2023-10-27

VLADIMIR DOSEN SURVEYING
 855 DUNDAS STREET WEST
 TORONTO, ONTARIO M6J 1K2
 PHONE: (416) 466-0140 EMAIL: VLADIMIR@VDOSEN.COM